

This document is the property of Amphenol Corporation and is delivered on the express condition that it is not to be disclosed, reproduced or used, in whole or in part, for any purpose other than that for which it was prepared. Amphenol Corporation and its subsidiaries and affiliates shall not be held liable for any errors or omissions or to use any information in this document.

REVISIONS				
SYM	ECN	DESCRIPTION	DATE	APPROVED
A	HK2613	RELEASE TO PRODUCTION	07/16/03	Y.M. Lee

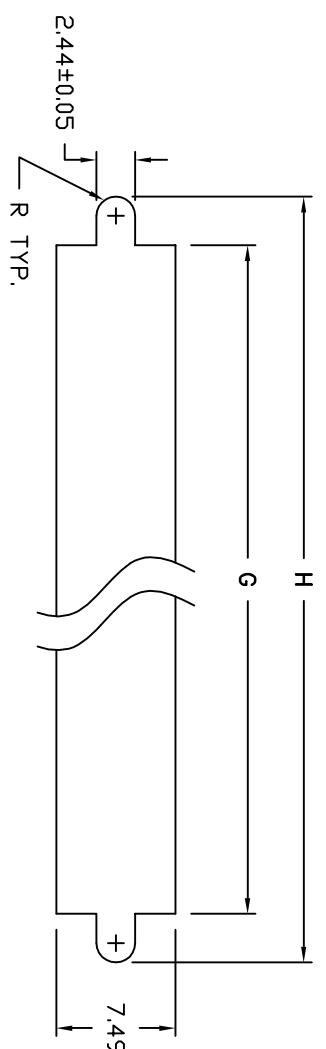
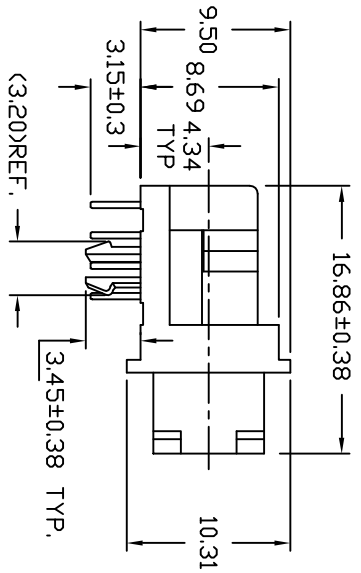
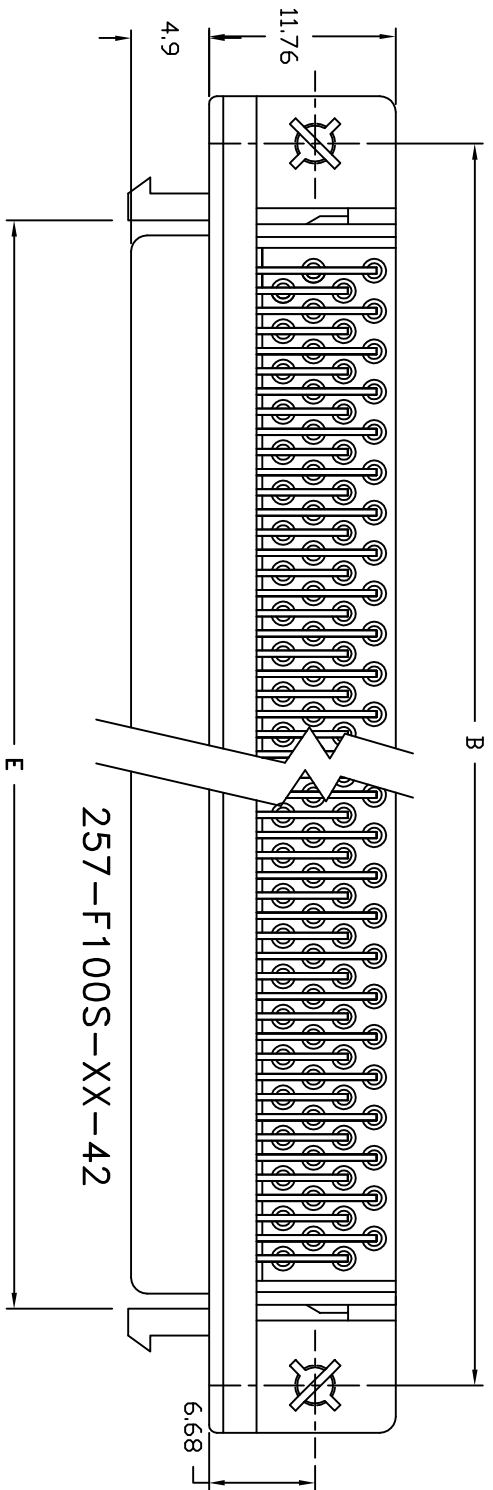
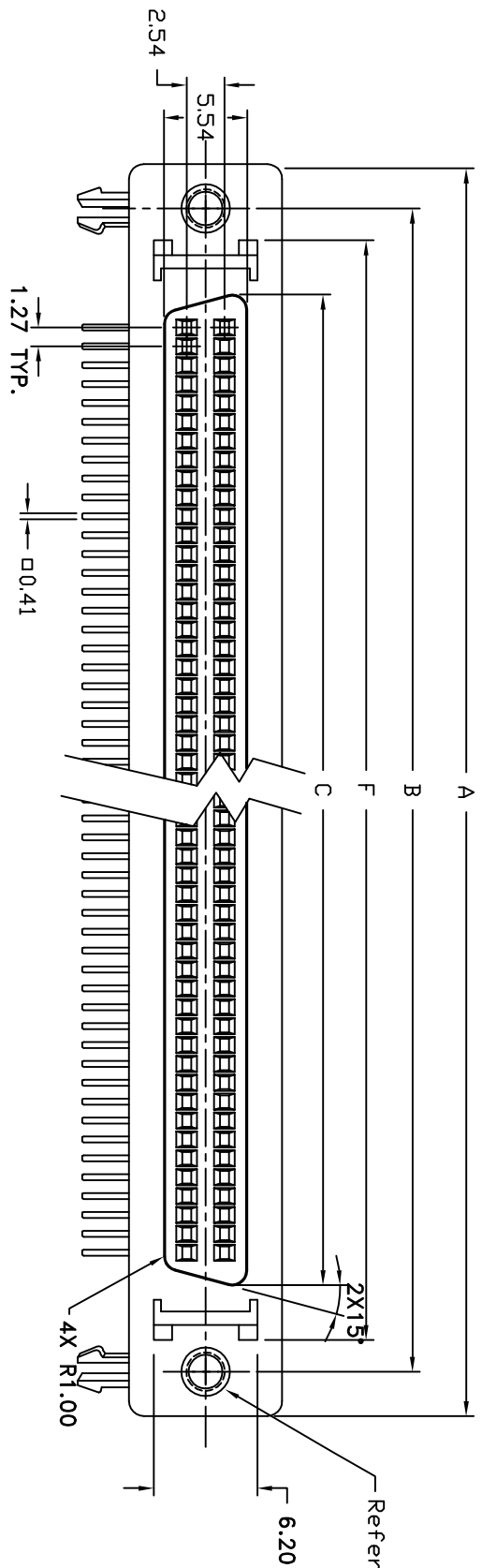

Part Number	No. of Contacts	A	B	C	D	E	F	G	H	Layout Style
257-F050S-XX-XX	50	52.45	46.48	34.70	30.48	37.29	42.29	42.80	48.92	1
257-F068S-XX-XX	68	63.88	57.91	46.13	41.91	48.72	53.72	54.23	60.35	2
257-F100S-XX-XX	100	84.20	78.23	66.45	62.23	69.04	74.04	74.55	80.67	2

CUSTOMER INFORMATION DRAWING

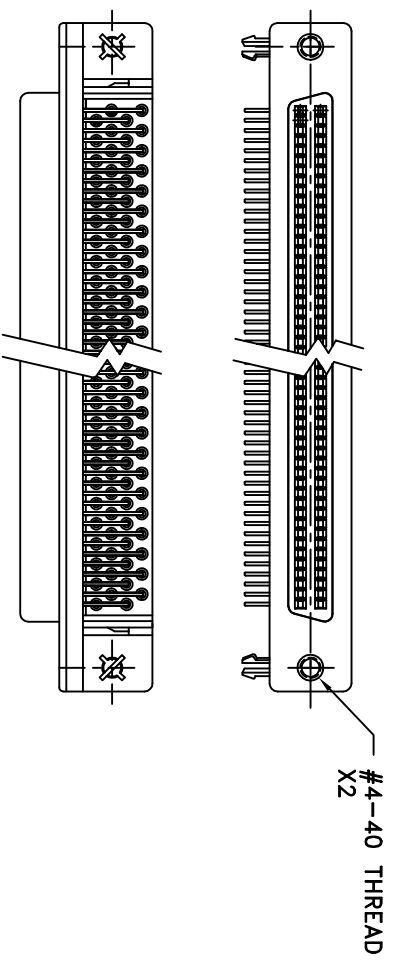

257-F100S-XX-92
SCALE: 1:2

UNLESS OTHERWISE SPECIFIED TOLERANCES U.S. METRIC		APPROVAL		DATE		TITLE	
X	+/-	0.20	DRAWN	Y.M. LEE	07/16/03	Amphenol	
.XX	+/-	0.13	CHECKED	Y.M. LEE	07/16/03	257 SCSI-2 RIGHT ANGLE, SHIELD RECEPTACLE CONNECTOR WITH LOCATION PLATE	
.XXX	+/-	0.10	DRAWING FILE: \DRAWING\257\C257FXXXREVA.DWG		SIZE: A3		
ANGLES +/-		3°	ANGLE OF PROJECTION		DRAWING NO. C257-FXXXS-XX-XX		
FOR MATERIALS AND FINISHES SEE NOTES		REMOVE SHARP EDGES		SCALE: NONE		REV. A	
DIMENSIONS		DIMENSIONS		SHEET 1 OF 2			
[U.S.]	[MM]	[FINCHES]		[MM]			

This document is the property of Amphenol Corporation and is delivered on the express condition that it is not to be disseminated, reproduced or used in any manner without the prior consent of Amphenol Corporation and that no right is granted to disclose or to use any information in this document.

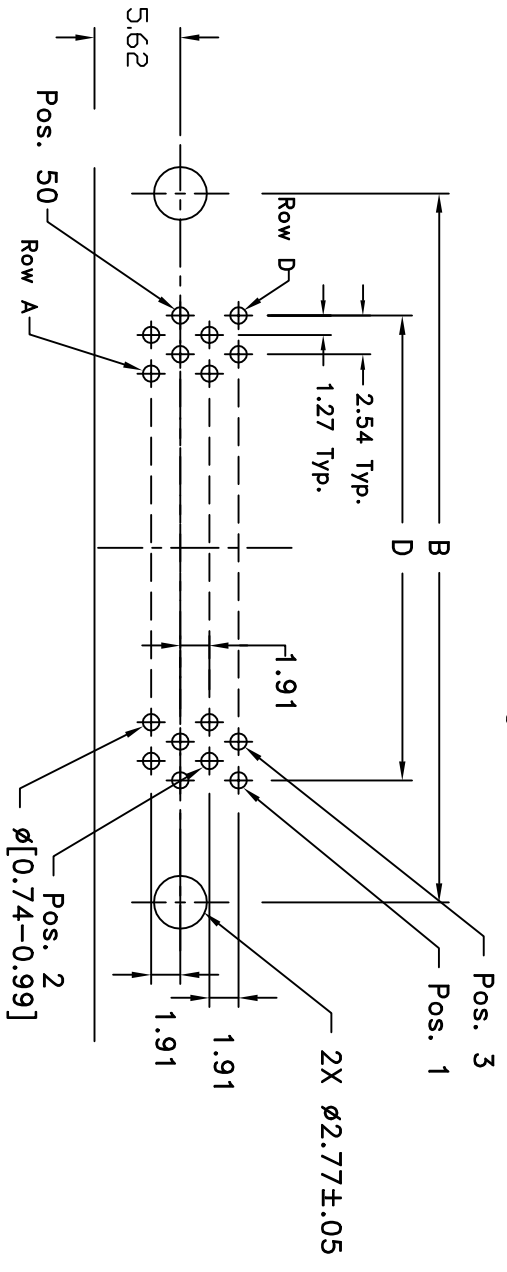
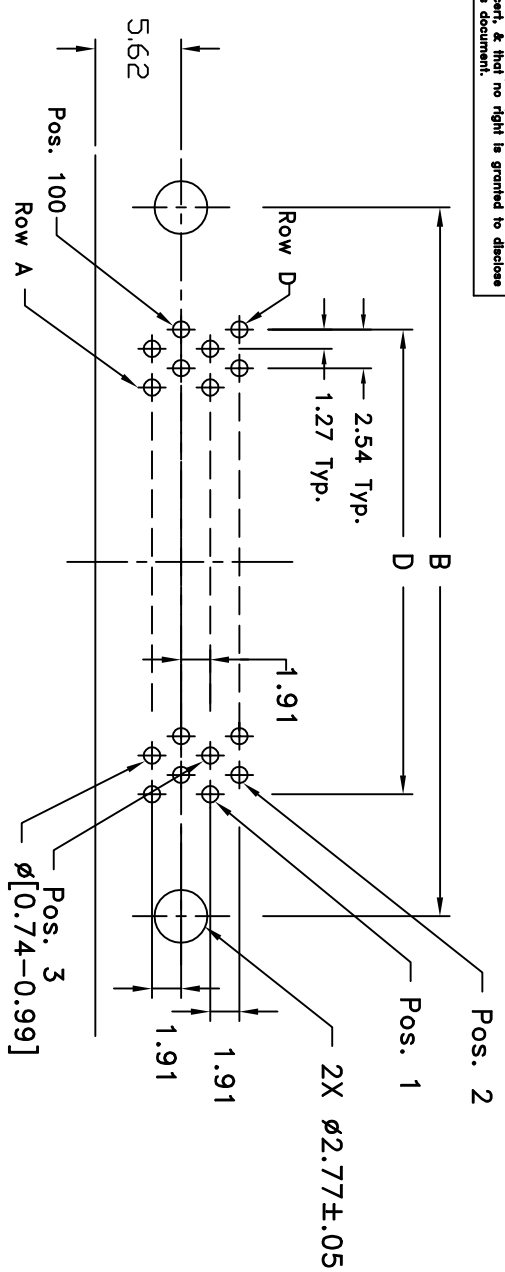

P/N System
257-FXXS-XX-XX
 Contact Type _____
 F - High temp. LCP material's body for board mount R/A 3.15mm tail
 No. of ways _____
 050 - 50 ways
 068 - 68 ways
 100 - 100 ways
 S - Socket (Female)
 P - Pin (Male)

Board Mounting Option (R/A bracket)
 2 - Boardlock
 3 - Clear hole
Panel Mount Option
 9 - #4-40 thr'd hole, w/o latch & rail
 6 - #2-56 thr'd hole, w/o latch & rail
 5 - #4-40 thr'd hole + latch block
 4 - #2-56 thr'd hole + latch block
 Plating Option

AA - Gold flash on mating area
 2.54-5.08µm Tin/Lead plated on termination area
 1.27-2.54µm Nickel underplated
AF - 0.38µm Gold plated on mating area
 2.54-5.08µm Tin/Lead plated on termination area
 1.27-2.54µm Nickel underplated
AM - 0.76µm Gold plated on mating area
 1.27-2.54µm Nickel underplated
 2.54-5.08µm Tin/Lead plated on termination area

Note:

- All dimensions are in mm.
- Materials
 - Contact : Phosphor Bronze,
 - AA - Gold flash on mating area
2.54-5.08µm Tin/Lead plated on termination area
1.27-2.54µm Nickel underplated
 - AF - 0.38µm Gold plated on mating area
2.54-5.08µm Tin/Lead plated on termination area
1.27-2.54µm Nickel underplated
 - AM - 0.76µm Gold plated on mating area
2.54-5.08µm Tin/Lead plated on termination area
1.27-2.54µm Nickel underplated
- Mechanical Characteristics
 - Shell : Cold Roll Steel, 5.08-7.62µm Tin/Lead plated.
 - Insulator : LCP, color black, UL94V-0 rated.
 - Die Casting bracket : Zine alloy 1.27-3.81µm Nickel plated with copper underplated.
- Electrical Characteristics
 - Contact Rating : 1 A Max.
 - Contact Resistance : 25 mΩ Max.
 - Insulation Resistance : 1000 MΩ Min.at 500 VDC
 - Operation Temperature : -55°C to 105°C
 - Dielectric Strength : 500 VAC
- Suitable for PCB with a nominal thickness of 1.56 mm
- Material should be fulfilled Amphenol Spec.# SSSN001.

CUSTOMER INFORMATION DRAWING

REVISIONS				
SYM	ECN	DESCRIPTION	DATE	APPROVED
A	HK	SEE SHEET 1		Y.M.LEE

UNLESS OTHERWISE SPECIFIED TOLERANCES		APPROVAL		DATE	
U.S.	METRIC	DRAWN	Y.M.LEE	07/16/03	
.X XX XXX FRACTIONS ANGLES +/-	0.20 0.13 0.10 3°	CHECKED	Y.M.LEE	07/16/03	
FOR MATERIALS AND FINISHES REMOVE SHARP EDGES		DRAWING FILE : \DRAWING\257\C257FXXSREV.A.DWG			
DIMENSIONS		ANGLE OF PROJECTION		TITLE	
U.S.	INCHES	FIRST ANGLE		257 SCSI-2 RIGHT ANGLE, SHIELD RECEPTACLE CONNECTOR WITH LOCATION PLATE	
(METRIC)	(MM)	SIZE	DRAWING NO.	SCALE	REV.
		A3	C257-FXXS-XX-XX	NONE	A
				SHEET 2	OF 2