

This document is the property of Amphenol Corporation and is delivered on the express condition that it is not to be disclosed, reproduced or used, in whole or in part, for manufacture or sale by anyone other than Amphenol Corporation without its prior consent, & that no right is granted to disclose or to use any information in this document.

REVISIONS				
SYM	ECN	DESCRIPTION	DATE	APPROVED
A		PRELIMINARY DESIGN	12/08/00	Y.M.LEE

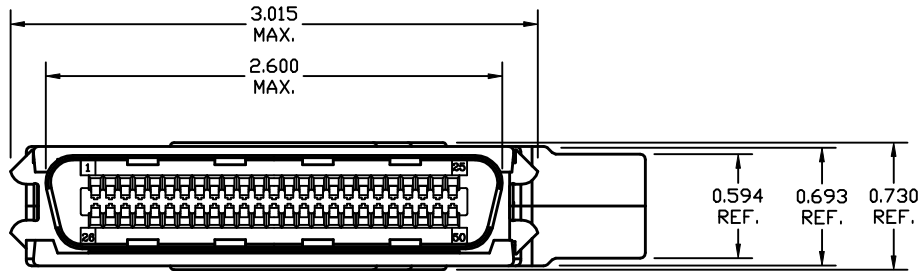
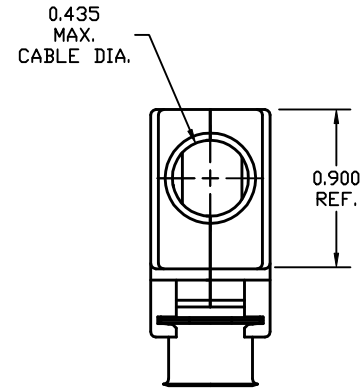
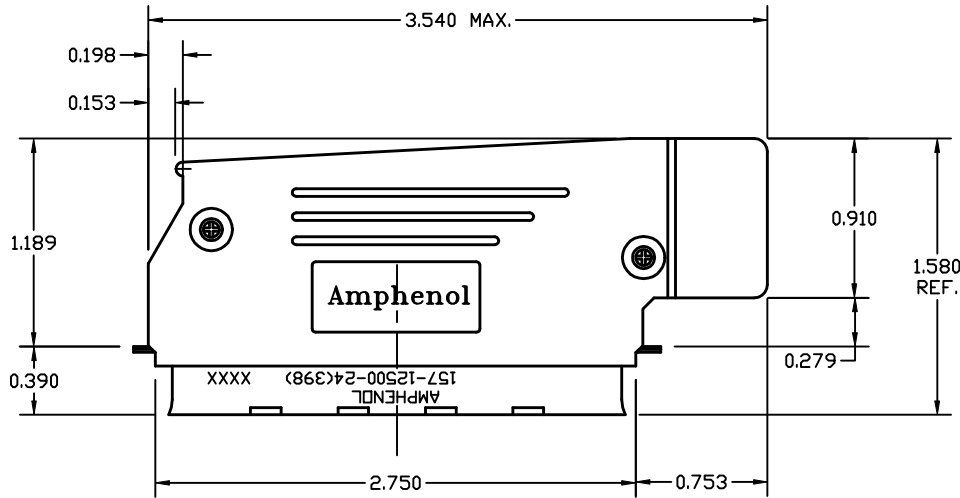

Material/Finish

- Plastic Insulator: PBT Glass fiber reinforced (UL 94V0) Gray
- Contact: Copper alloy/Gold plating
- Shell: Steel / Nickel plating
- Hood: Aluminum alloy
- Cable Clamp: Steel/Nickel plating

Specifications

- Voltage Rating: 700 VDC at sea level
- Current Rating: 5 Amps
- Insulation Resistance: >5000 M Ohms.
- Dielectric withstanding Voltage: 1200 VAC at sea level
- Termination: solderless IDC
- Wire: 24 and 26 AWG solid wire
- 26 and 28 AWG stranded wire

CUSTOMER INFORMATION DRAWING

ITEM NO	PART OR IDENTIFICATION NO	NOMENCLATURE OR DESCRIPTION	QTY REQ'D
PARTS LIST			
UNLESS OTHERWISE SPECIFIED TOLERANCES		APPROVAL	DATE
U.S. METRIC		DRAWN Ming LI	12/08/00
.X +/- 0.020		CHECKED Y.M. LEE	12/08/00
.XX +/- 0.010		CHECKED	
.XXX +/- 0.005			
FRACTIONS +/-			
ANGLES +/- 1°			
FOR MATERIALS AND FINISHES SEE NOTES		DRAWING FILE :	
REMOVE SHARP EDGES		ANGLE OF PROJECTION	
DIMENSIONS			
U.S.	INCHES		SIZE
(METRIC)	(MM)		DRAWING NO.
		A3	C157-12500-24(398)
		SCALE	NONE
		SHEET 1 OF 1	

Amphenol

TITLE 50 CONTACT PLUG ASSEMBLY ADAPTED FOR SPRING LATCH WITH RIGHT ANGLE HOOD

Amphenol East Asia Limited Manufacturing Operation

REV. A

This document is the property of Amphenol Corporation and is delivered on the express condition that it is not to be disclosed, reproduced or used, in whole or in part, for manufacture or sale by anyone other than Amphenol Corporation without its prior consent, and that no right is granted to disclose or to use any information in this document.

REVISIONS				
SYM	ECN	DESCRIPTION	DATE	APPROVED
A		PRELIMINARY DESIGN	12/08/00	Y.M.LEE

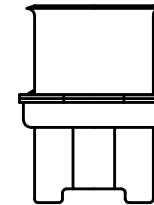
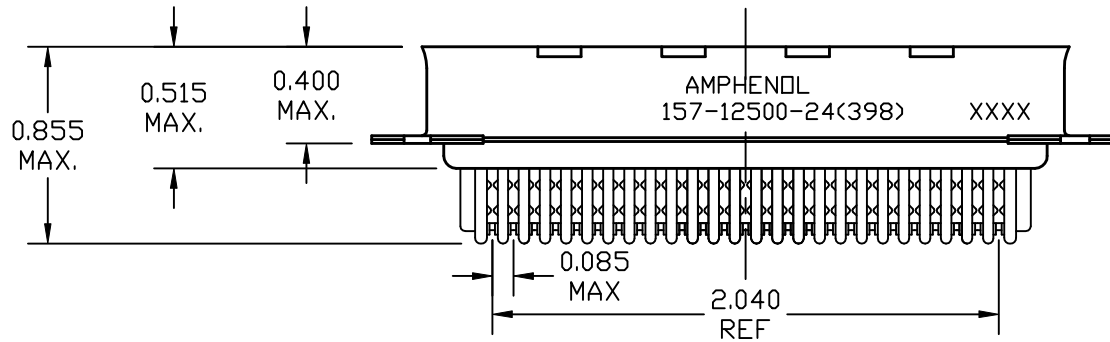
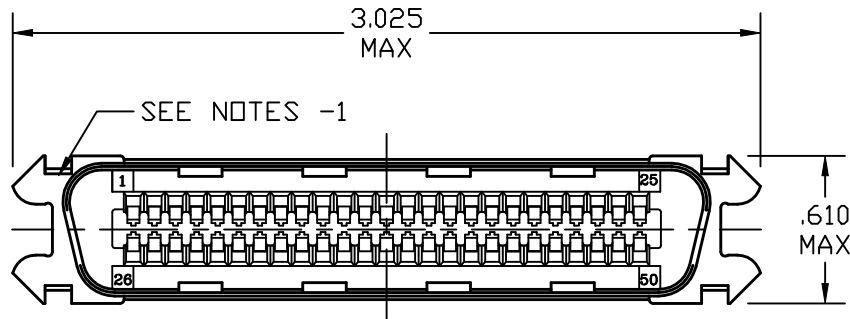

NOTES:

1. MARK DATE CODE ONLY (DO NOT INCLUDE SOURCE CODE) PER AMPH.SPEC. #123-269 AND #123-306, USE BKACK INK 30-515-03, CHARACTERS TO BE TO BE 1/16 TO 3/32 HIGH LOCATED IN AREA SHOWN
2. MARK PART NO."157-12500-24(398)" & "AMPHENOL" USING BLACK INK PER 30-515-03, CHARACTERS TO BE 1/16" HIGH AND LOCATED IN AREA SHOWN
3. STAKE TAB ON BACK SHELL ,OVER TIP FLANGE-SURFACE OF FRONT SHELL, AS SHOWN

CUSTOMER INFORMATION DRAWING

ITEM NO	PART OR IDENTIFICATION NO	NOMENCLATURE OR DESCRIPTION	QTY REQ'D
PARTS LIST			
UNLESS OTHERWISE SPECIFIED TOLERANCES		APPROVAL	DATE
U.S. METRIC		DRAWN Ming LI	12/08/00
.X +/- 0.020		CHECKED Y.M. LEE	12/08/00
.XX +/- 0.010		CHECKED	
.XXX +/- 0.005			
FRACTIONS +/-		DRAWING FILE :	
ANGLES +/- 1°		\\DRAWING\157\1250024RA.DWG	
FOR MATERIALS AND FINISHES SEE NOTES		ANGLE OF PROJECTION	
REMOVE SHARP EDGES			
DIMENSIONS			
U.S. INCHES			
-(METRIC)-			
		SIZE DRAWING NO.	REV.
		A3 C157-12500-24(398)	A
		SCALE NONE	SHEET 2 OF 2

Amphenol

Amphenol East Asia Limited
Manufacturing Operation

TITLE 50 CONTACT PLUG ASSEMBLY
ADAPTED FOR SPRING LATCH
WITH RIGHT ANGLE HOOD

