

## Panel Cut Out

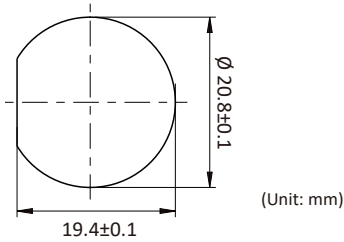

Specification		Type C	
Rated Voltage (AC/DC)		30V (DC)	
Nominal Current		Up To 5A	
Data Transfer Rate		3.2 Gen 2	
Plastic / Metal		Plastic	Metal
Receptacle, Square Flang, <b>FRONT</b> Fastened Nut, IP67 (Unmated) Connector/Contact Gender: Male Connector Female Contact   Screw Thread Nut Torque Value: 3.5 ~ 5 kgf.cm   Recommended Panel Thickness: with cap: 2.8mm, without cap: 4.0mm			
<p>Y-beam (Packed With Finish Product)</p>	Y-beam, Flex. PCB	UC-00PMFY-SC7001	USC-00PMFY-SC7001*
<b>STRAIGHT-TO-STRAIGHT, Overmolded Double-Ended Cable Assembly, IP67 (Mated), With Plastic Interlocking Conduit</b> ⑩ Cable Length: USB 3.2 Gen 2: (A05) 0.5M ~ (003) 3M			
	End 1 Type C: Male Connector Female Contact End 2 Type C: Male Connector Male Contact	UC30ML-UCML-SC ⑩*	USC30ML-USCML-SC ⑩*
	End 1 Type C: Male Connector Female Contact End 2 Type C: Female Connector Male Contact	UC30ML-UCFL-SC ⑩*	USC30ML-USCFL-SC ⑩*
	End 1 Type C: Male Connector Female Contact End 2 Non-Waterproof Type C: Male Connector Male Contact	UC30ML-NCML-SC ⑩*	USC30ML-NCML-SC ⑩*
<b>STRAIGHT-TO-STRAIGHT, Overmolded Double-Ended Cable Assembly, IP67 (Mated), Without Conduit</b> ⑩ Cable Length: USB 3.2 Gen 2: (A05) 0.5M ~ (003) 3M			
	End 1 Type C: Male Connector Female Contact End 2 Type C: Male Connector Female Contact	UC30ML-NUCML-SC ⑩*	USC30ML-NUCML-SC ⑩*
	End 1 Type C: Male Connector Female Contact End 2 Type C: Female Connector Male Contact	UC30ML-NUCFL-SC ⑩*	USC30ML-NUCFL-SC ⑩*
	End 1 Type C: Male Connector Female Contact End 2 Non-Waterproof Type C: Male Connector Male Contact	UC30ML-NNCML-SC ⑩*	USC30ML-NNCML-SC ⑩*
<b>STRAIGHT-TO-STRAIGHT, Overmolded Double-Ended Cable Assembly, IP67 (Mated), With Plastic Interlocking Conduit</b> ⑩ Cable Length: USB 3.2 Gen 2: (A05) 0.5M ~ (003) 3M			
	End 1 Type C: Female Connector Male Contact End 2 Type C: Female Connector Male Contact	UC30FL-UCFL-SC ⑩*	USC30FL-USCFL-SC ⑩*
	End 1 Type C: Female Connector Male Contact End 2 Non-Waterproof Type C: Male Connector Male Contact	UC30FL-NCML-SC ⑩	USC30FL-NCML-SC ⑩
<b>STRAIGHT-TO-STRAIGHT, Overmolded Double-Ended Cable Assembly, IP67 (Mated), Without Conduit</b> ⑩ Cable Length: USB 3.2 Gen 2: (A05) 0.5M ~ (003) 3M			
	End 1 Type C: Female Connector Male Contact End 2 Type C: Female Connector Male Contact	UC30FL-NUCFL-SC ⑩*	USC30FL-NUCFL-SC ⑩*
	End 1 Type C: Female Connector Male Contact End 2 Non-Waterproof Type C: Male Connector Male Contact	UC30FL-NNCML-SC ⑩*	USC30FL-NNCML-SC ⑩*

Mating

Pair

\* Upon Request