

AMPHENOL INDUSTRIAL PRODUCTS GROUP

BATTERY AND GROUNDING SOLUTIONS

Diego Fossati

diego.fossati@amphenol.de

POWER DISTRIBUTION FOR INDUSTRIAL VEHICLES

Amphenol Industrial group offers interconnections dedicated to power distribution and ground wiring for industrial vehicles

- Grounding quick interconnection
- Battery positive/negative pole quick interconnection
- Power distribution for multiple wires
- Grounding collectors for multiple wires

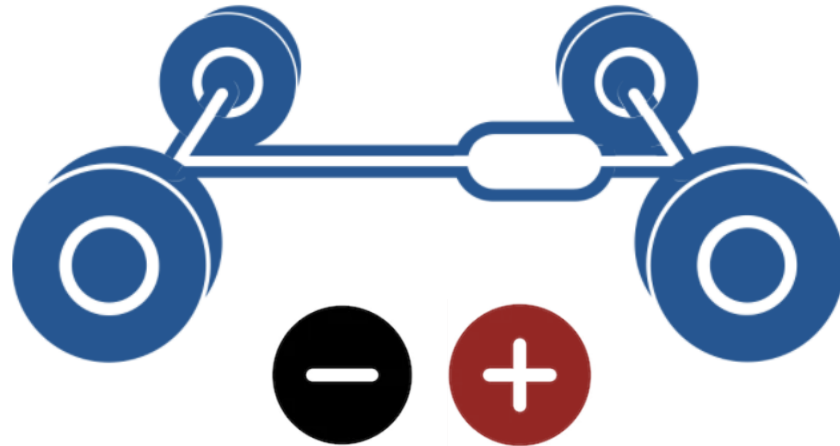
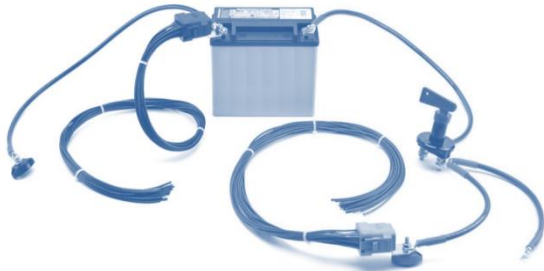

POWER DISTRIBUTION PRODUCTS OVERVIEW

ACTIVE PINLOCK®



SURLOK PLUS®



RADLOK®



ATP HYPERBUSS



ATV HYPERBUSS



AT HYPERBUSS

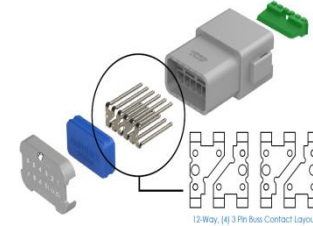

Amphenol Radsok®

ACTIVE PINLOCK

POWER CABLE

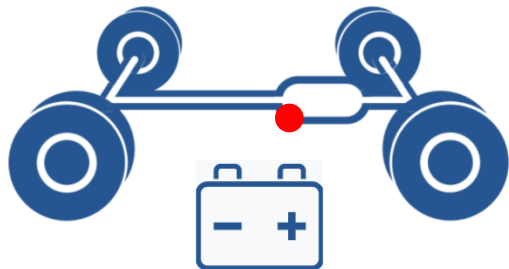

CONTACT TYPE	CRIMP W/ RADSOK ®
CONTACT WIRE GAUGE	6-50MM ²
EMI OPTION	NO
HARDWARE COUPLING MECHANISM	PUSH PULL + LOCKING
IP RATING MATED	IP2X
MATERIAL SHELL	PLASTIC
MATING CYCLES	100
MAX CURRENT RATING	200A
OPERATING TEMPERATURE	-40°C TO + 120°C
OPERATING VOLTAGE	60V

No coding options
Available up to 60V applications



Amphenol Radsok®



SURLOK PLUS

GROUNDING & POSITIVE/NEGATIVE

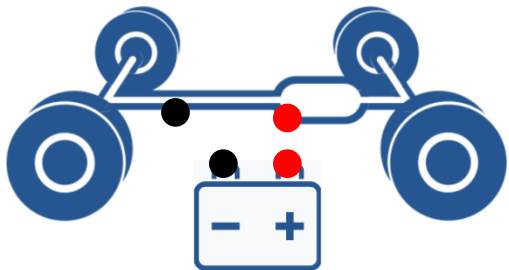

CONTACT TYPE	CRIMP W/ RADSOK ®
CONTACT WIRE GAUGE	6-95MM ²
EMI OPTION	YES
HARDWARE COUPLING MECHANISM	PUSH PULL + LOCKING
IP RATING MATED	IP67 – IP6K9K - IP2X
MATERIAL SHELL	PLASTIC
MATING CYCLES	100
MAX CURRENT RATING	450A
OPERATING TEMPERATURE	-40°C TO + 125°C
OPERATING VOLTAGE	1000V

**Colour and mechanical coding options
Available for High Voltage applications**



Amphenol Radsok®

RADLOK

GROUNDING & POSITIVE/NEGATIVE

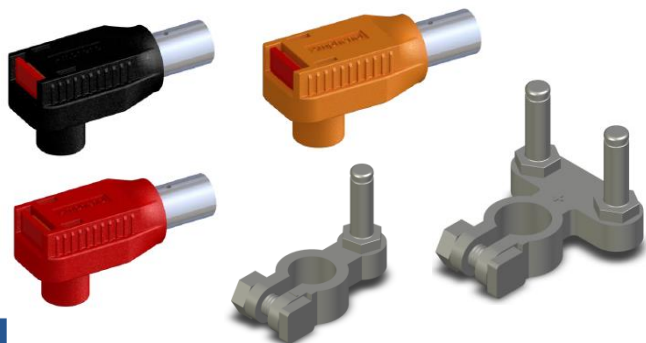
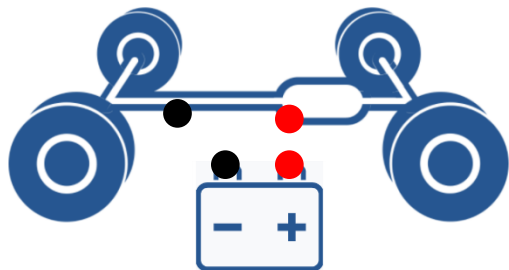

CONTACT TYPE	CRIMP W/ RADSOK ®
CONTACT WIRE GAUGE	10-150MM ²
EMI OPTION	NO
HARDWARE COUPLING MECHANISM	PUSH PULL + LOCKING
IP RATING MATED	IP40
MATERIAL SHELL	PLASTIC
MATING CYCLES	100
MAX CURRENT RATING	650A
OPERATING TEMPERATURE	-40°C TO + 125°C
OPERATING VOLTAGE	1000V

Colour coding options
Available for High Voltage applications



Amphenol Radsok®

ATV HYPERBUSS

POWER DISTRIBUTION & GROUNDING COLLECTOR

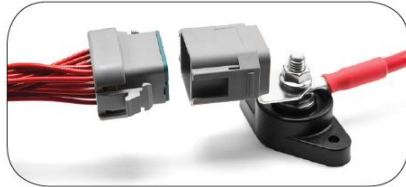
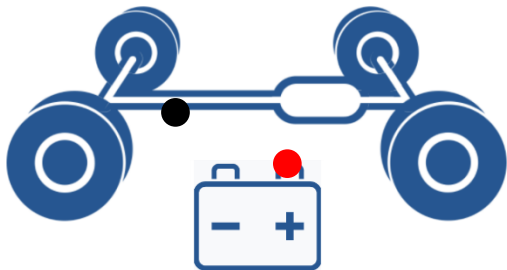

CONTACT TYPE	CRIMP
CONTACT WIRE GAUGE	0.34-2.5MM ²
DIELECTRIC VALUE	> 1500V
HARDWARE COUPLING MECHANISM	PUSH PULL + LOCKING
IP RATING MATED	IP67
MATERIAL SHELL	PLASTIC
MATING CYCLES	100
MAX CURRENT RATING	MAX TOTAL 230A (18 WAYS)
OPERATING TEMPERATURE	-55°C TO + 125°C
NUMBER OF CONTACTS	18 WAYS

Colour and mechanical coding options

ATP HYPERBUSS

POWER DISTRIBUTION & GROUNDING COLLECTOR

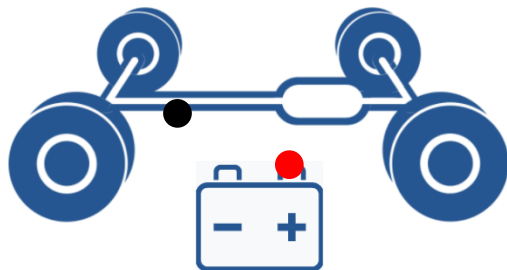

CONTACT TYPE	CRIMP
CONTACT WIRE GAUGE	1.5-6MM ²
DIELECTRIC VALUE	> 1500V
HARDWARE COUPLING MECHANISM	PUSH PULL + LOCKING
IP RATING MATED	IP68
MATERIAL SHELL	PLASTIC
MATING CYCLES	100
MAX CURRENT RATING	MAX TOTAL 150A (6 WAYS)
OPERATING TEMPERATURE	-55°C TO + 125°C
NUMBER OF CONTACTS	6 WAYS

Colour and mechanical coding options

AT HYPERBUSS

POWER DISTRIBUTION

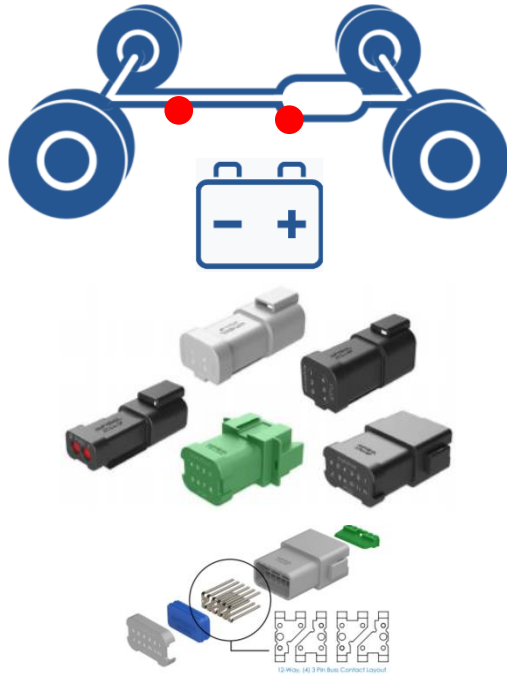

CONTACT TYPE	CRIMP
CONTACT WIRE GAUGE	0.34-2.5MM ²
DIELECTRIC VALUE	> 1500V
HARDWARE COUPLING MECHANISM	PUSH PULL + LOCKING
IP RATING MATED	IP67
MATERIAL SHELL	PLASTIC
MATING CYCLES	100
MAX CURRENT RATING	MAX TOTAL 78A PER BUSS
OPERATING TEMPERATURE	-55°C TO + 125°C
NUMBER OF CONTACTS	2-4-6-8-12 WAYS

Colour and mechanical coding options

A 3D rendered image of two white robotic hands, one on the left and one on the right, holding thick, metallic cables. The hands are positioned as if they are about to connect or have just connected the cables. The background is a dark blue gradient with faint, out-of-focus images of various industrial connectors. The overall aesthetic is clean, modern, and industrial.

YOUR PARTNER FOR INTERCONNECTING SOLUTIONS